

HOSE PINCH VALVES



Female Threaded: 1/2 - 1 1/4" (Fig 103A) 1/2" - 4" (Fig 103B)
 Working pressure max.: 6 bar (Fig 103A)
 Working pressure max.: 4 bar (Fig 103B)

Operating: By Air, Water, Neutral gasses, 2-6 bar



Flanged EN1092-2 : DN40-150: PN16, DN200-300: PN10
 (Fig 103)

Working pressure max.: 6 bar DN40 - 100
 Working pressure max.: 4 bar DN125-200
 Working pressure max.: 3 bar DN250-300 (4 bar on request)
 Operating: By Air, Water, Neutral gasses, 2-6 bar



Flanged EN1092-2 PN16 to Storz coupling : DN40-150
 (Fig 103)

Working pressure max.: 6 bar DN40 - 100
 Working pressure max.: 4 bar DN125-200

Operating: By Air, Water, Neutral gasses, 2-6 bar



With heating - all flanged types

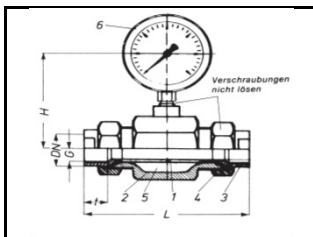

Manometer with inline seal
 1/2" - 1 1/4"
 DN40-100

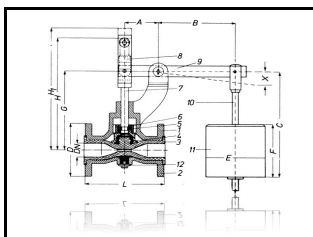

Hose diaphragm float valve DN20-80

HOSE DIAPHRAGM VALVES



Flanged EN1092-2 : DN40-150: PN16, DN200-300: PN10
(Fig 101)
Working pressure max.: 6 bar DN15-80
Working pressure max.: 4 bar DN100
Working pressure max.: 3 bar DN125-200
Operating: Handwheel



Flanged EN1092-2 : DN15-200
Operating: Diaphragm pneumatic actuator



Flanged EN1092-2 : DN15-200
Operating: Piston pneumatic actuator



Flanged EN1092-2 : DN15-200
Operating: Electrical actuator



Flanged EN1092-2 : DN15-150
As "Safety valve" overflow valve



Spare Hose for Diaphragm type:
Natural rubber, NBR, Neoprene CR, Butyl IIR, Hypalon, EPDM.